



# EXPERT ENGINEERING SERVICES

FOR ALL YOUR CRITICAL  
SEALING & SELF-LUBRICATED  
BEARING APPLICATIONS

EXPERTISE

INNOVATION

PERFORMANCE OPTIMISATION

SHARED KNOWLEDGE

IN-HOUSE TESTING



## Repack-S®

ALL YOU EXPECT  
IN SEALING EXPERTISE



## 1 EXPERT HELP AT HAND

### PROBLEM SOLVING & DETAILED ANALYSIS

- Fact finding
- Data acquisition
- Failure root cause analysis
- Detailed (onsite) inspections
- Complete diagnostic



## 2 INNOVATIVE CREATIONS

### STATE-OF-THE-ART DESIGN & DEVELOPMENT CAPABILITIES

- Concept brief & set of performance targets
- Environmental constraints analysis
- Functional analysis
- Concept review vs. expectations
- Stage-gate decision process
- Full 3-D rendering

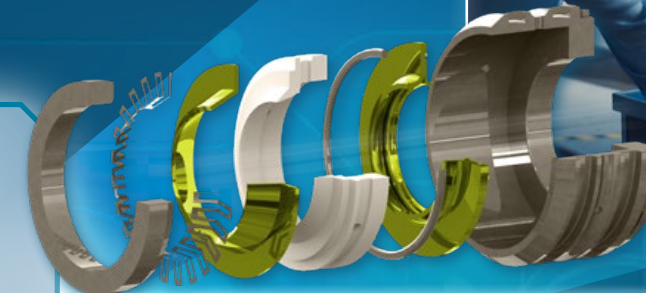
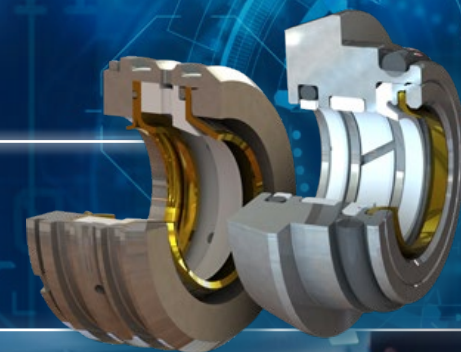

## 5 IN-HOUSE TESTING TO REDUCE RISKS & COSTS

### TEST TO MINIMISE COSTS OF REACHING GOALS

- Sealing effectiveness
- System reactivity
- Extrusion resistance
- Endurance
- Friction / Power consumption
- System efficiency

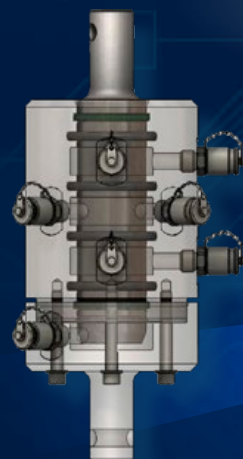

### A COMPREHENSIVE RANGE OF EXPERT ENGINEERING SERVICES TO HELP YOU...

- IMPROVE** knowledge & understanding
- ACHIEVE** performance & reliability goals
- ACCELERATE** product development
- REDUCE** uncertainties & risk of failure
- REDUCE** overall costs

## 3 ACCELERATE DEVELOPMENT CYCLE

### PREDICT BEHAVIOUR & OPTIMISE PERFORMANCE

- During system assembly
- Determine contact pressures
- Evaluate stresses & strains in key components
- Integrate thermal considerations
- Anticipate impact of system vibrations



## 4 ENHANCE KNOWLEDGE

### MATERIAL & SOLUTION CHARACTERISATION

- Tensile, compressive & relaxation behaviour from -100°C to +300°C
- Ageing characteristics
- Chemical compatibility
- Tribological properties
- Impact of hysteresis & shock loading

72.995  
51.238  
815  
101146  
XC270







# Repack-S<sup>®</sup>

[WWW.REPACK-S.COM](http://WWW.REPACK-S.COM)

ALL YOU EXPECT  
IN SEALING EXPERTISE

## Repack-S

Z.I. du Bois Bernoux  
71290 Cuisery | France

☎ +33 (0) 385 321 014

☎ +33 (0) 385 325 212

[contact@repack-s.com](mailto:contact@repack-s.com)

Paris •

Lyon •

Geneva •

CERTIFICATION

**ISO 9001 : 2015**

N° AE389